



Principal Particulars

Length overall	18.5	metres
Length waterline	17	metres
Moulded beam	7.4	metres
Design draught	1.2	metres

Deadweight

Technicians	12	
Crew	3	
Cargo	7	tonnes
Fuel	5,000	litres
Fresh water	500	litres
Black water	500	litres
Maximum deadweight	14	tonnes

Performance & Range

Speed	28	knots
Service speed	24.5	knots

Machinery

Main engines	2 x CAT C18 ACERT 651kW
Propulsors	2 x FP Propellers

Construction

Aluminium

Design Standard

Class	MCA MGN 280
Flag	MCA MGN280 Cat 2



Year launched
2013/2014

Number built
1

Owner
Turbine Transfers

Project No
NG859

Builder
Buckie Shipyard / Holyhead
Marine

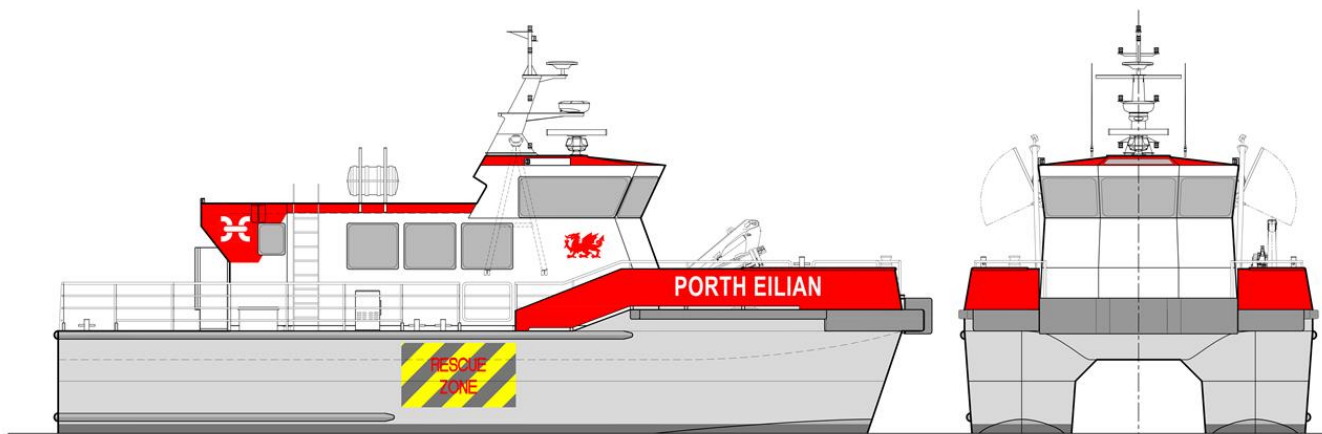

OUTBOARD PROFILE

VIEW ON BOW

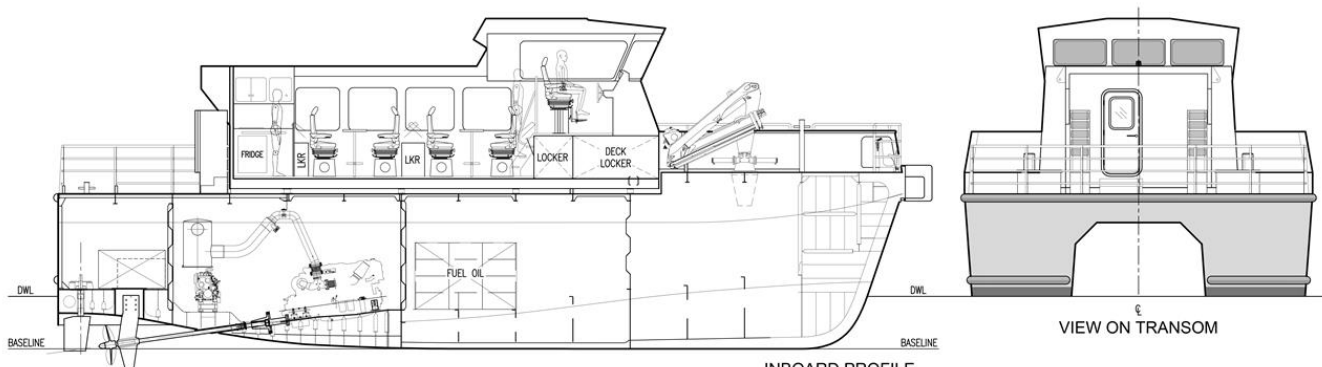

INBOARD PROFILE

VIEW ON TRANSOM

TRANSOM	FR.0	FR.1	FR.2	FR.3	FR.4	FR.5	FR.6	FR.7	FR.8	FR.9	FR.10	FR.11	FR.12	FR.13	FR.14
	1200	2400	3600	4800	6000	7200	8400	9600	10800	12000	13200	14400	15600	16800	

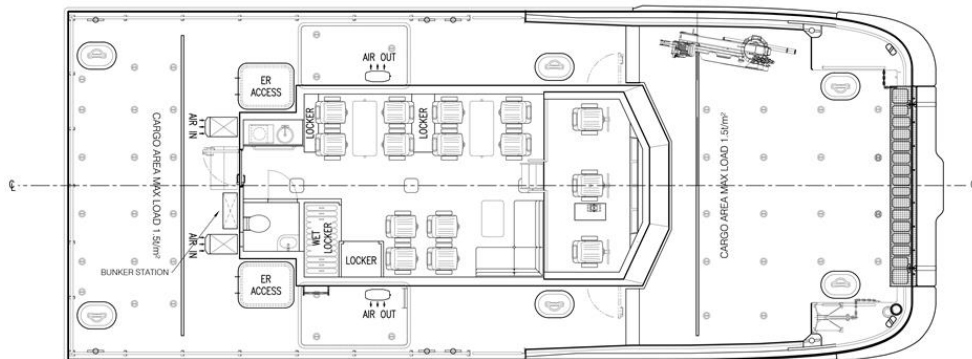

PLAN VIEW ON MAIN DECK

TRANSOM	FR.0	FR.1	FR.2	FR.3	FR.4	FR.5	FR.6	FR.7	FR.8	FR.9	FR.10	FR.11	FR.12	FR.13	FR.14
	1200	2400	3600	4800	6000	7200	8400	9600	10800	12000	13200	14400	15600	16800	

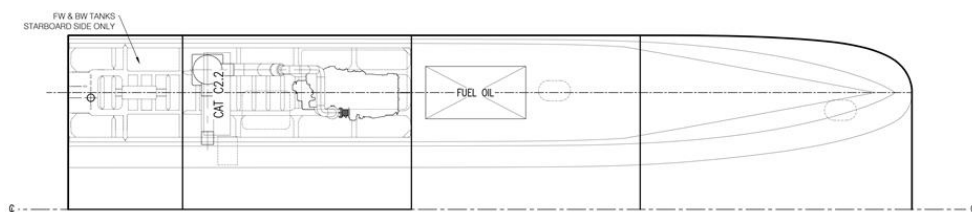

HALF PLAN VIEW ON HULL