



Principal Particulars

Length overall	18.3	metres
Length waterline	17	metres
Moulded beam	6.8	metres
Design draught	1.9	metres

Deadweight

Passengers	60	
Crew	3	
Fuel	3,500	litres
Fresh water	800	litres
Maximum deadweight	12.3	tonnes

Performance & Range

Speed	12	knots
Service speed	11	knots

Machinery

Main engines	2 x Cummins 6CTA 8.3M3 @ 261 kW
Propulsors	2 x Fixed Pitch Propeller

Construction

Hull	Steel
Superstructure	Aluminium

Design Standard

Class	LR 100A1 SSC G2:LMC, MCA MSN 1699(M) CI IV & VI(A)
-------	--



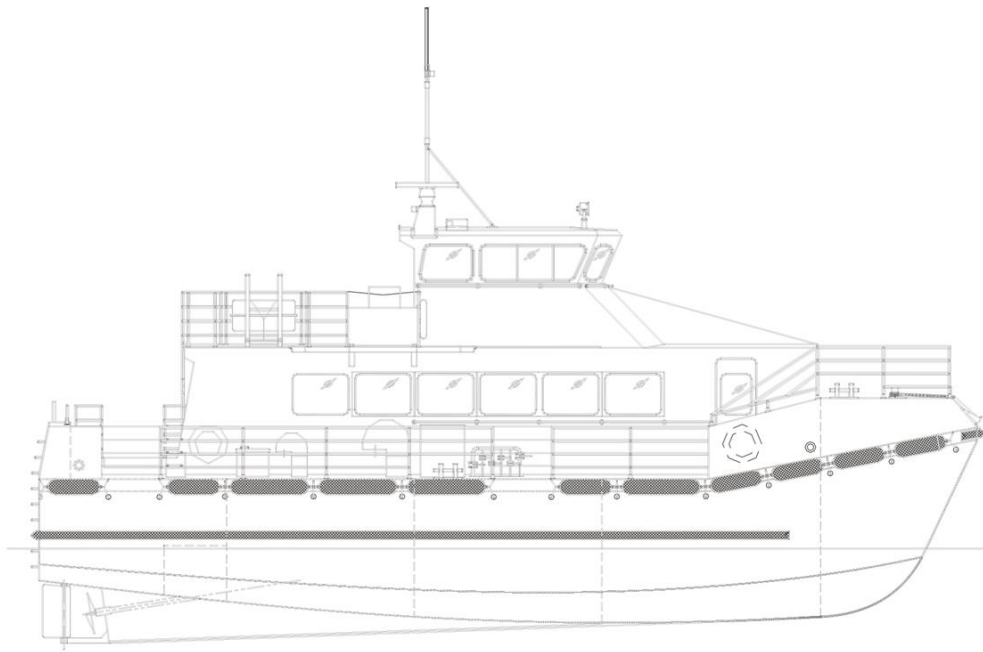

Outboard Profile

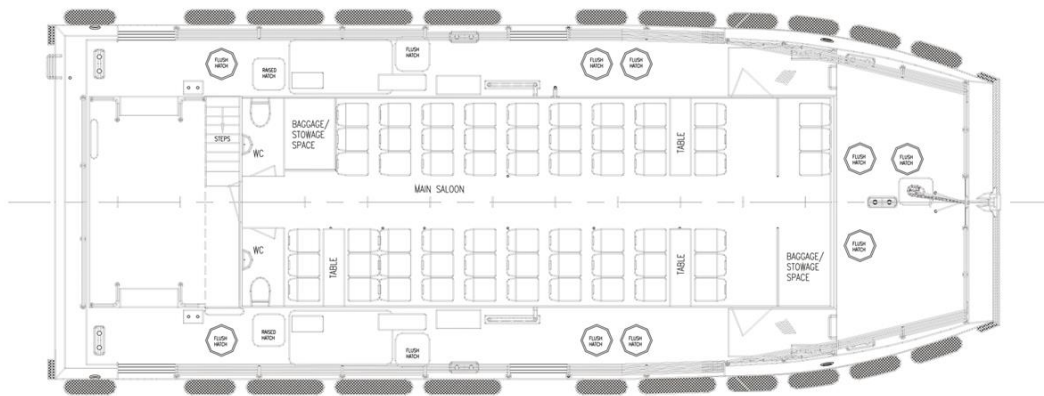

Passenger Deck Plan

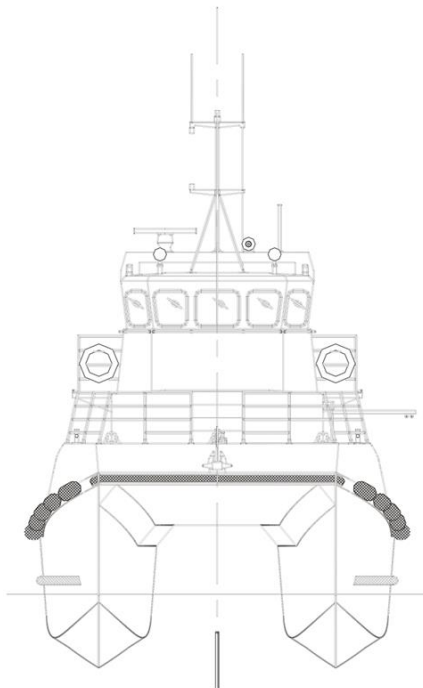

Bow View

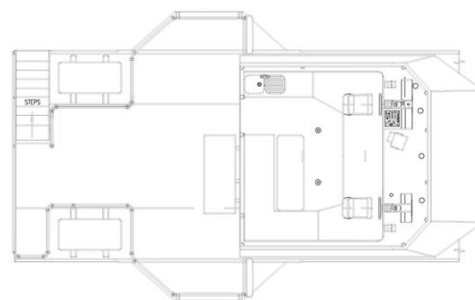

Bridge Deck Plan