

24m Patrol Boat



Principal Particulars

Length overall	23.9	metres
Length waterline	20.2	metres
Moulded beam	5.7	metres
Design draught	1.2	metres

Deadweight

Officers	3	
Crew	5	
Fuel	6,600	litres
Fresh water	1,300	litres
Maximum deadweight	12	tonnes

Performance & Range

Speed	38	knots
-------	----	-------

Machinery

Main engines
3 x MTU 12V 2000 M84 2 x 1220kw

Propulsors
3 x Rolls Royce 50A3 Waterjets

Construction

Composite

Design Standard

Class
Turk Loydu

Flag
Qatar Flag

Owner

Qatar Coastguard

Builder

Ares Shipyard Ltd

No Built

5 under construction

Project No

NG955

Year Launched

2016

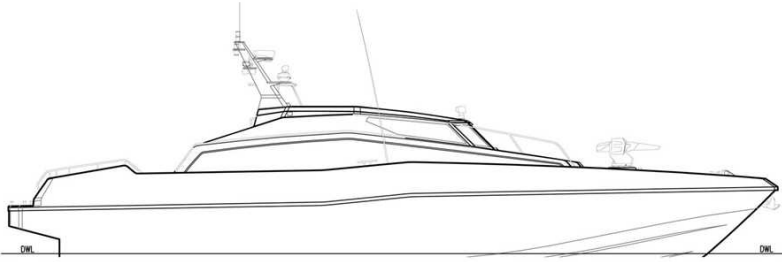

OUTBOARD PROFILE
LOOKING TO PORT

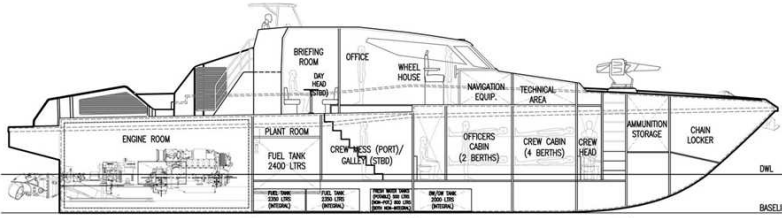

INBOARD C/L PROFILE
LOOKING TO PORT

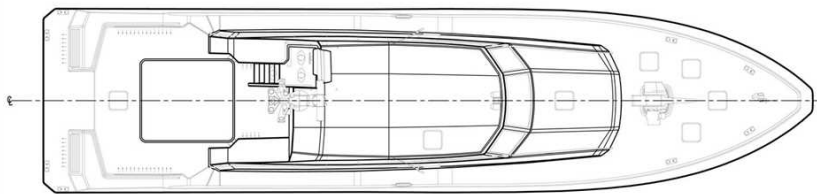

TOP VIEW

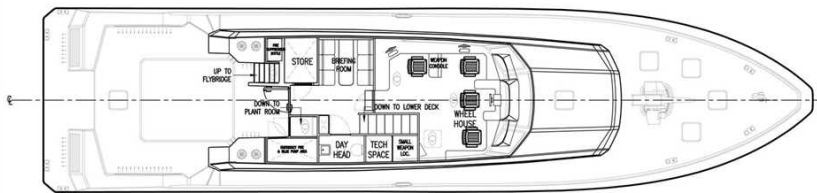

MAIN DECK

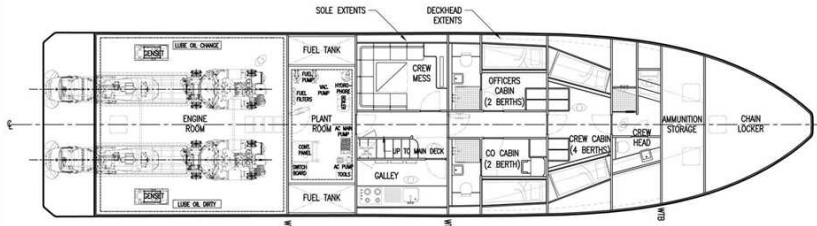

LOWER DECK

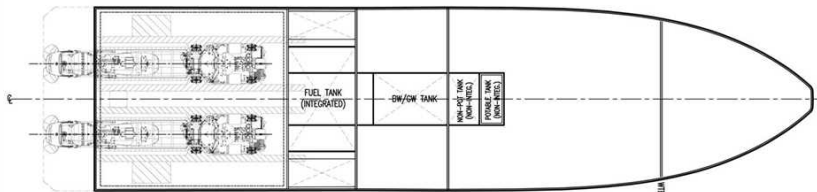

TANK DECK