

# 18m Crew Boat



## Principal Particulars

Length overall	18.3	metres
Length waterline	17	metres
Moulded beam	6.8	metres
Design draught	1.9	metres

## Deadweight

Passengers	60	
Crew	3	
Fuel	3,500	litres
Fresh water	800	litres
Maximum deadweight	12.3	tonnes

## Performance & Range

Speed	12	knots
Service speed	11	knots

## Machinery

### Main engines

2 x Cummins 6CTA 8.3M3 @ 261 kW

### Propulsors

2 x Fixed Pitch Propeller

## Construction

### Hull

Steel

### Superstructure

Aluminium

## Design Standard

### Class

LR 100A1 SSC G2:LMC, MCA MSN 1699(M)  
CI IV & VI(A)

## Owner

Serco-Denholm Shipping

## Builder

Aluminium Ship Builders

## No Built

4

## Project No

NG316

## Year Launched

2000

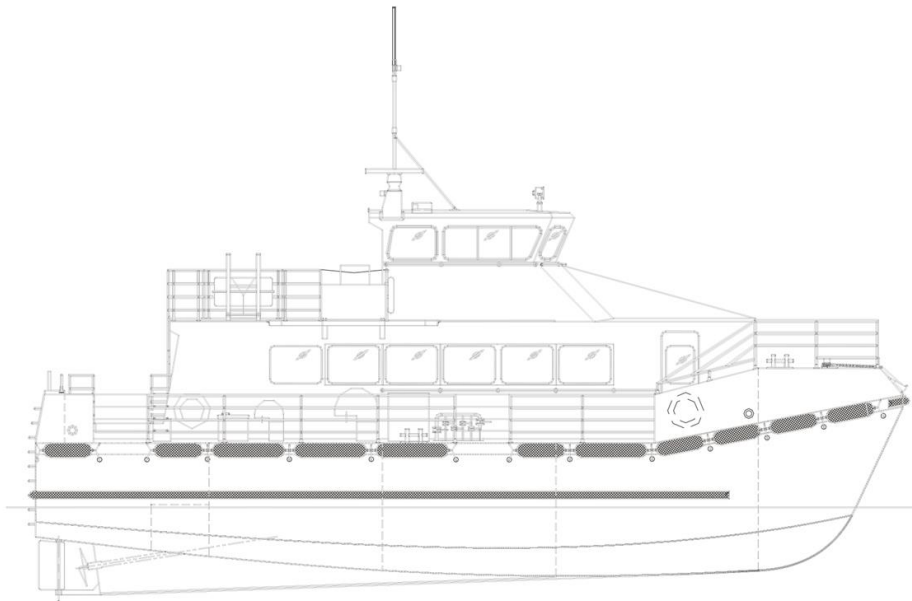

**Outboard Profile**

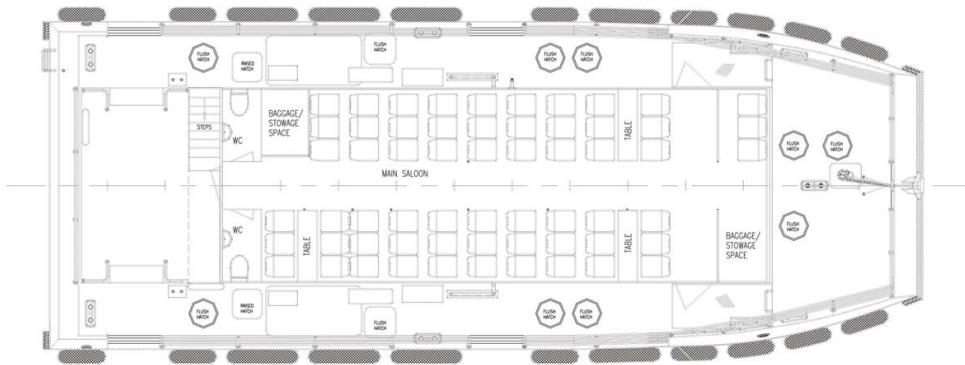

**Passenger Deck Plan**

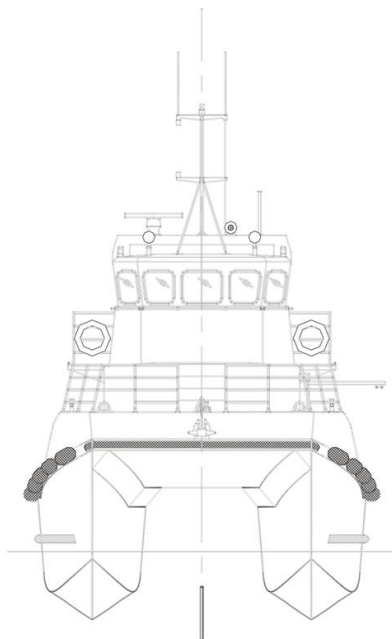

**Bow View**

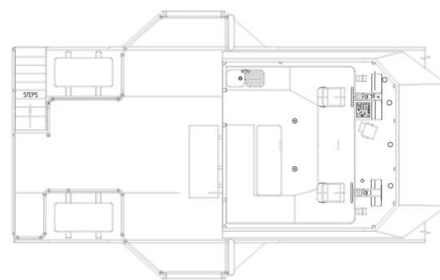

**Bridge Deck Plan**