

## 26m Crew Boat

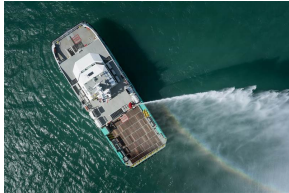

### Principal Particulars

<b>Length overall</b>	26.2	metres
<b>Length waterline</b>	22.9	metres
<b>Moulded beam</b>	8.5	metres
<b>Design draught</b>	1.5	metres

### Deadweight

<b>Passengers</b>	60	
<b>Crew</b>	6	
<b>Cargo</b>	15	tonnes
<b>Fuel</b>	23,500	litres
<b>Fresh water</b>	9,100	litres
<b>Maximum deadweight</b>	34.5	tonnes

### Performance & Range

<b>Speed</b>	27.0	knots
--------------	------	-------

### Machinery

**Main engines**  
2 x CAT C32 ACERT

**Power**  
1081kW

**Propulsors**  
2 x Fixed Pitch Propeller

### Construction

Aluminium

### Design Standard

**Class**  
Bureau Veritas

**Flag**  
Crew Boat Sea Area 2

### Owner

Pelican

### Project No

NG969

### Builder

Penguin Shipyard

### Year Launched

2015

### No Built

1

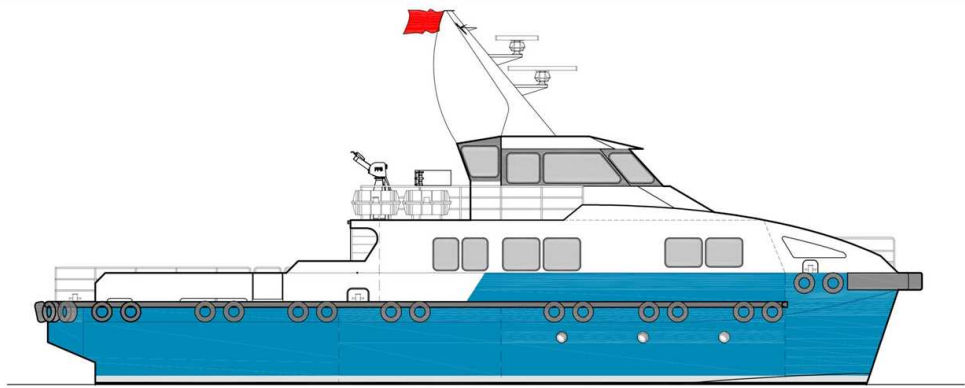

OUTBOARD PROFILE

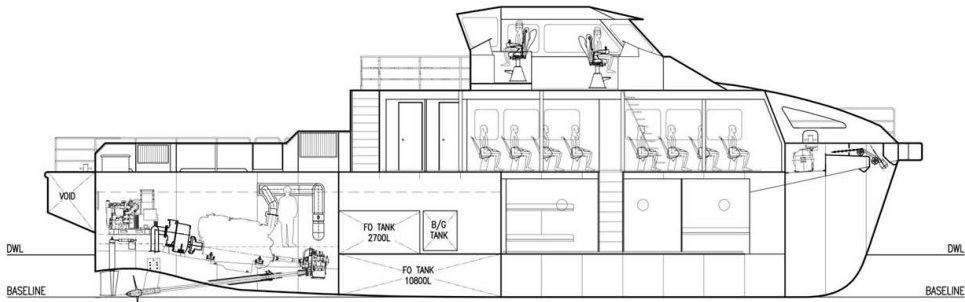

INBOARD PROFILE

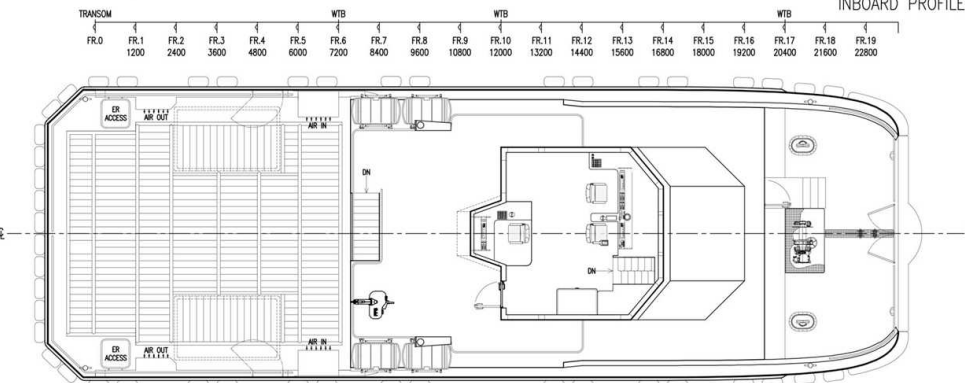

PLAN VIEW BRIDGE

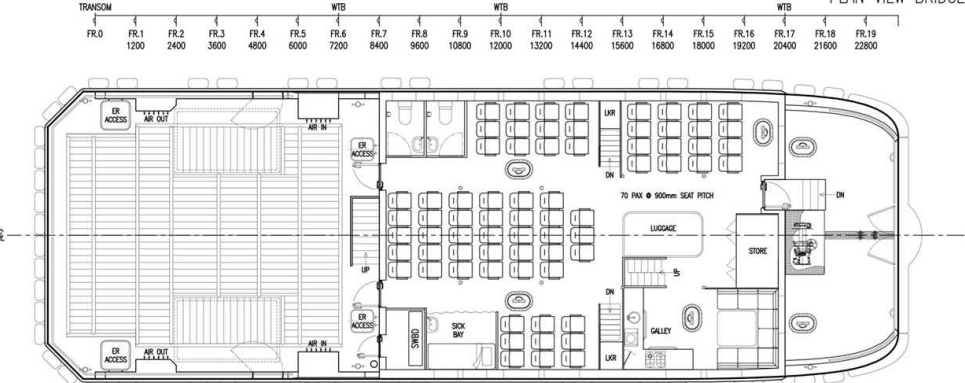

PLAN VIEW ON MAIN DECK

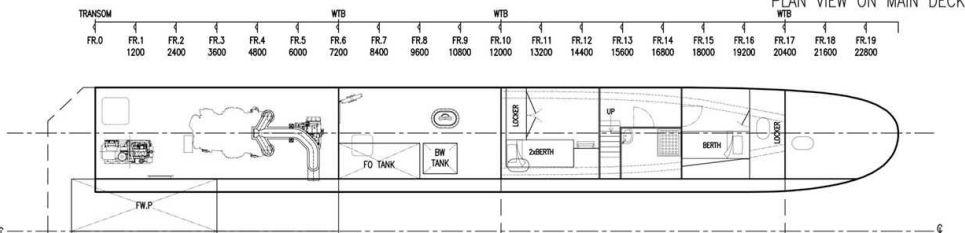

Building 14, Shamrock Quay, William Street,  
 Southampton, Hampshire, SO14 5QL, United  
 Kingdom

**Tel:** +44 (0)23 8022 6655  
**E-mail:** shipdesign.cs@bmtglobal.com  
**Web:** www.bmt.org