



Principal Particulars

Length overall	39.9	metres
Length waterline	36.8	metres
Moulded beam	9	metres
Design draught	1.5	metres

Deadweight

Passengers	385	
Crew	5	
Fuel	10,000	litres
Fresh water	1,500	litres
Black water	1,500	litres

Performance & Range

Speed	25	knots
Service speed	20	knots

Machinery

Main engines	2 x CAT C32 1081 kW @ 2100
Propulsors	2 x Fixed Pitch Propellers

Design Standard

Class	LR100A1,SSC,PASSENGER MONO,HSC,G3,+LMC,UMS
Flag	Irish DOT





OUTBOARD PROFILE

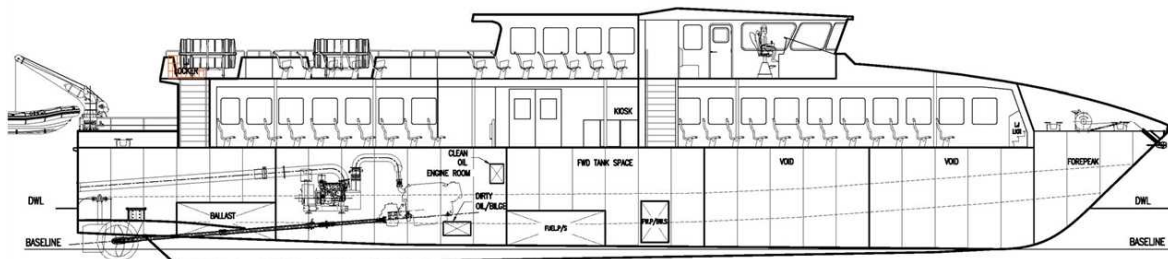

INBOARD PROFILE

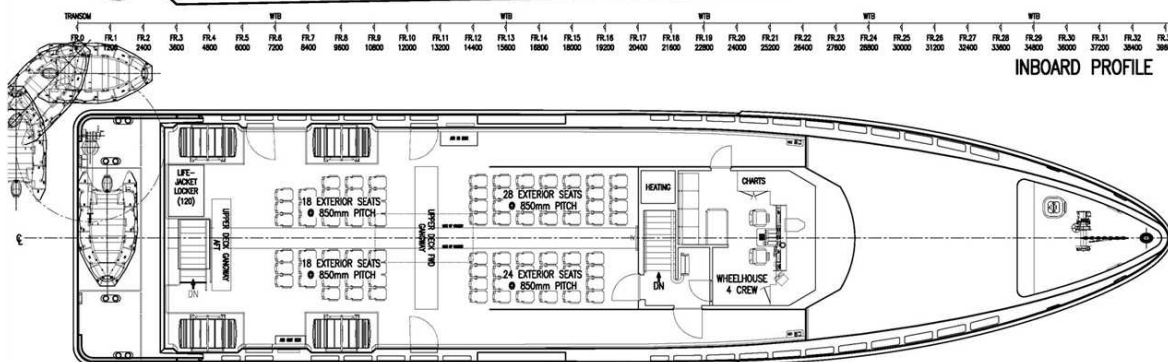

PLAN VIEW ON UPPER DECK

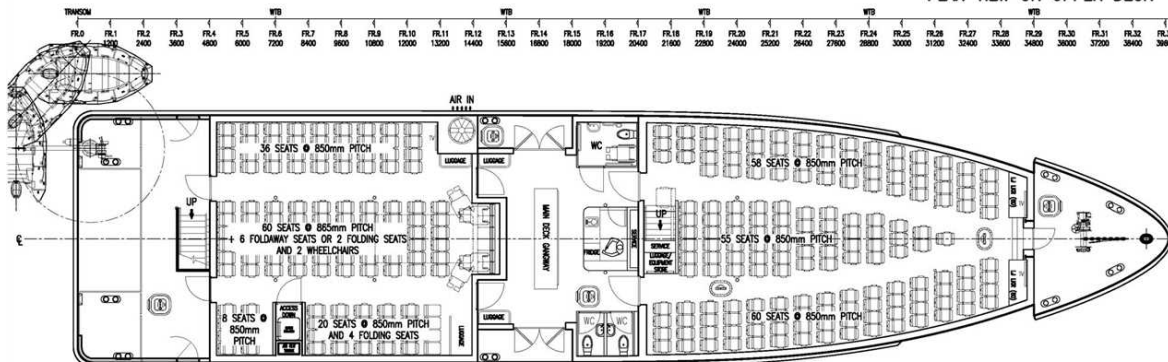

PLAN VIEW ON MAIN DECK

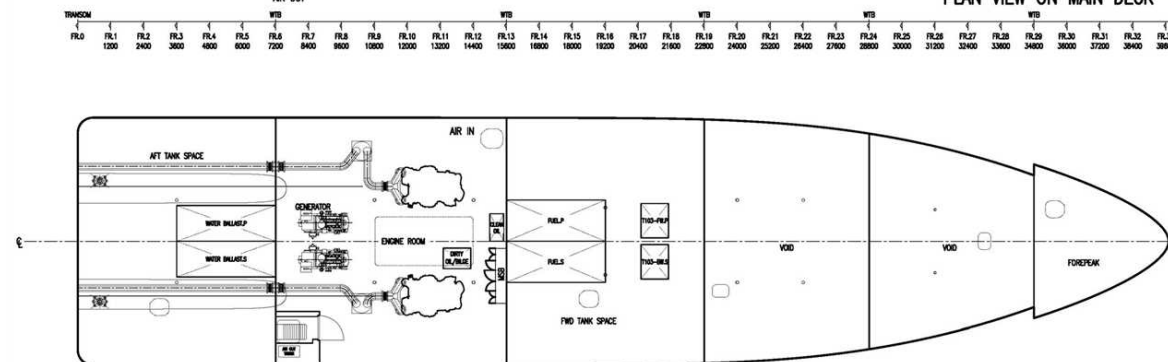

PLAN VIEW ON HULL