



Principal Particulars

Length overall	27.4	metres
Length waterline	25.6	metres
Moulded beam	8.9	metres
Design draught	1.5	metres

Deadweight

Passengers	24	
Crew	3	
Fuel	35,000	litres
Fresh water	3,500	litres
Black water	2,500	litres
Maximum deadweight	44	tonnes

Performance & Range

Speed	26.0	knots
Service speed	24.0	knots

Machinery

Main engines	2x CAT C32 (1081kW)
Propulsors	2x FPP
Hybrid propulsion systems	

Design Standard

Class	BV
Flag	United Kingdom

Additional Information

Crane - PK12000
Active Fender System® 2
Resilient Mounted Superstructure



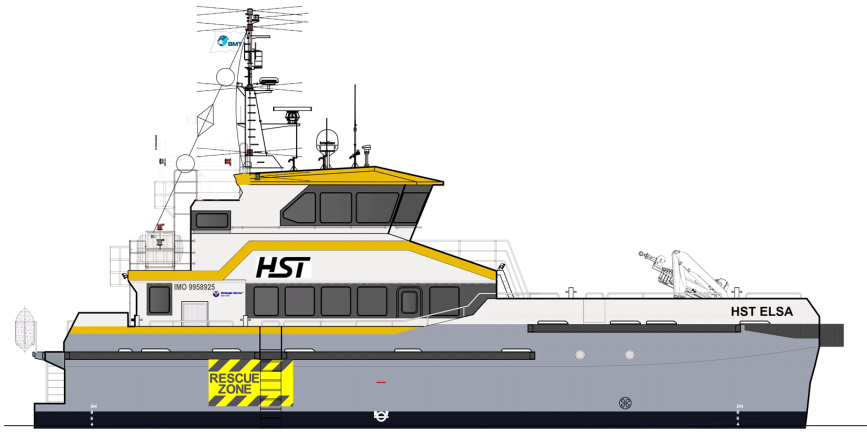

OUTBOARD PROFILE

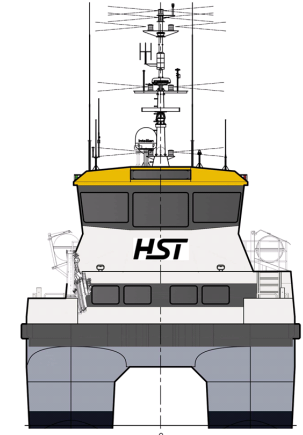

VIEW ON BOW

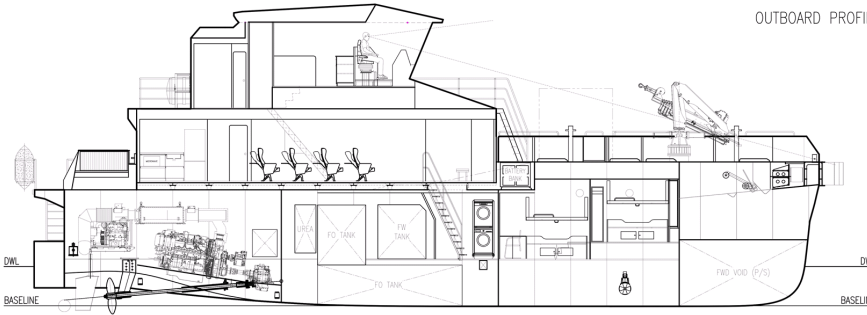

INBOARD PROFILE

FR.0	FR.1	FR.2	FR.3	FR.4	FR.5	FR.6	FR.7	FR.8	FR.9	FR.10	FR.11	FR.12	FR.13	FR.14	FR.15	FR.16	FR.17	FR.18	FR.19	FR.20	FR.21
TRANSOM	1200	2400	3600	4800	6000	7200	8400	9600	10800	12000	13200	14400	15600	16800	18000	19200	20400	21100	22300	23500	24700

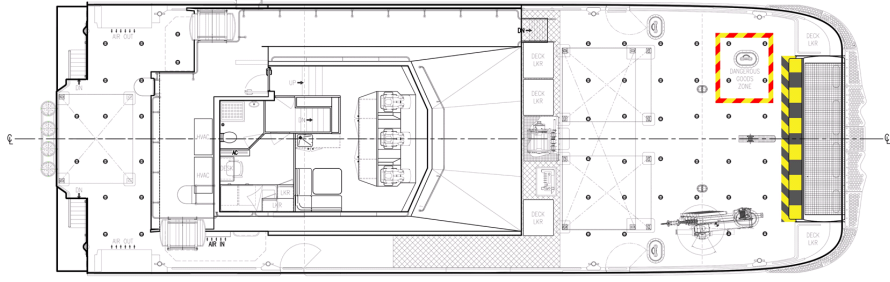

PLAN VIEW BRIDGE

FR.0	FR.1	FR.2	FR.3	FR.4	FR.5	FR.6	FR.7	FR.8	FR.9	FR.10	FR.11	FR.12	FR.13	FR.14	FR.15	FR.16	FR.17	FR.18	FR.19	FR.20	FR.21
TRANSOM	1200	2400	3600	4800	6000	7200	8400	9600	10800	12000	13200	14400	15600	16800	18000	19200	20400	21100	22300	23500	24700

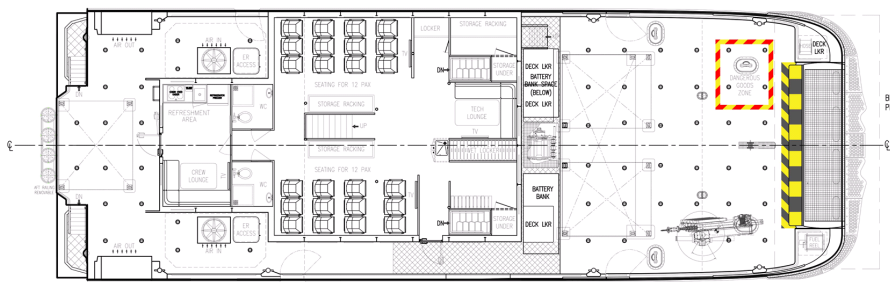

PLAN VIEW ON MAIN DECK

FR.0	FR.1	FR.2	FR.3	FR.4	FR.5	FR.6	FR.7	FR.8	FR.9	FR.10	FR.11	FR.12	FR.13	FR.14	FR.15	FR.16	FR.17	FR.18	FR.19	FR.20	FR.21
TRANSOM	1200	2400	3600	4800	6000	7200	8400	9600	10800	12000	13200	14400	15600	16800	18000	19200	20400	21100	22300	23500	24700

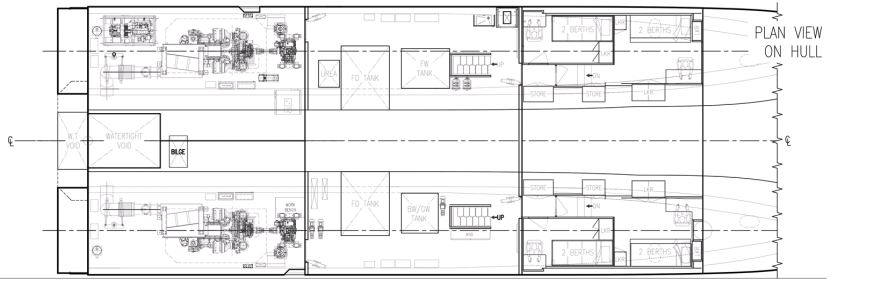

PLAN VIEW ON HULL

BMT ACTIVE FENDER SYSTEM
PROTECTED BY PATENT No. GR2490252